

### Quick Guide

Ver. 1.2  
Release date: 1.2025  
Soft: V1.40.145



Producer:  
Engo Controls sp. z o.o. sp. k.  
Rolna 4 St.  
43-262 Kobieliце  
Poland

[www.engocontrols.com](http://www.engocontrols.com)

### Technical specification

Power supply	Built-in lithium battery
Power supply port	USB typ C
Communication	Wi-Fi 2.4GHz
Resolution	4Mpx 2560*1440P
Local storage	Micro SD(Max 256GB) - card not included Minimum requirements of a microSDXC card -full HD speed class - C10/U1/V10
IP protection class	IP65
Dimmension [mm]	125x48x77

### Product Compliance

This product complies with the following EU Directives:  
2014/53/EU, 2011/65/EU.

### Introduction

The ECAM-SOLAR camera is the ideal solution for outdoor surveillance, combining reliability, convenience and eco-friendliness. With a built-in 5200mAh Li-Ion battery and solar panel included, the camera can operate 100% wirelessly, eliminating the need for any wiring. It is ideal for locations where it is difficult to access a permanent power source. Designed for outdoor installation, the ECAM-SOLAR camera features IP65 waterproofing, ensuring it can withstand rain, dust and other adverse weather conditions.

### Product features

**FHD** 4Mpx 2560\*1440P

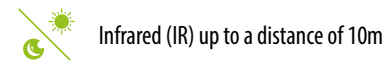
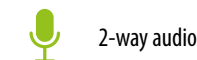

### Safety Information:

Use in accordance with national and EU regulations. Use the device only as intended. Installation must be carried out by a qualified person in accordance with national and EU regulations.

### Installation:

Installation must be performed by a qualified person with appropriate electrical qualifications, in accordance with the standards and regulations in force in a given country and in the EU. The manufacturer is not responsible for non-compliance with the instructions.



### WARNING:

For the entire installation, there may be additional protection requirements, which the installer is responsible for (e.g., installation of an additional differential pressure overflow valve).

### Camera description

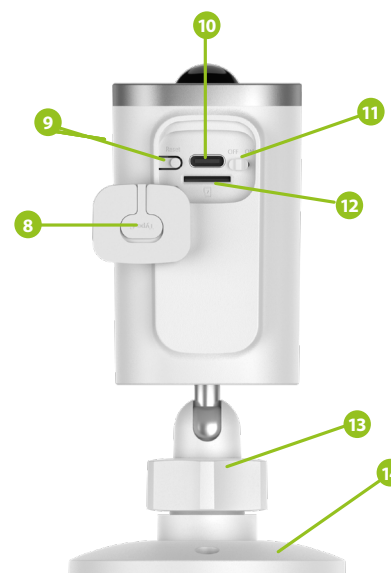
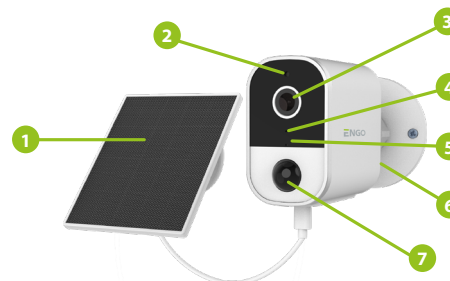

1. Solar panel
2. Light sensor
3. Camera lens
4. Microphone
5. LED diode
6. Loudspeaker
7. Motion sensor
8. Moisture protection
9. Reset button
10. USB type C power socket
11. Device on/off switch
12. Micro SD slot
13. Locking nut for adjusting the mounting angle
14. Mounting bracket

### Installation of the camera in the app

Make sure your router is within range of your smartphone. Make sure you are connected to the Internet. This will reduce the pairing time of the device.

#### STEP 1 - DOWNLOAD ENGO SMART APP

Download the ENGO Smart app from Google Play or Apple App Store and install it on your smartphone.



#### STEP 2 - REGISTER THE NEW ACCOUNT

To register a new account, please follow the steps below:

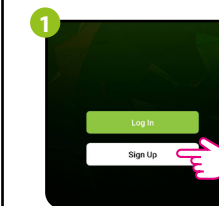

Click „Sign Up“ to create new account.

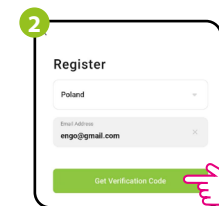

Enter your e-mail address to which the verification code will be sent.

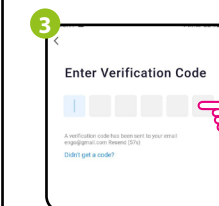

Enter the verification code received in the email. Remember that you only have 60 seconds to enter the code!

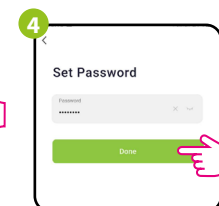

Then set the login password.

### STEP 3 - CONNECT CAMERA TO WI-FI

After installing the app and creating an account:

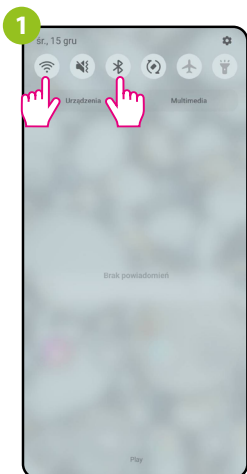

On your mobile device, make sure the ENGO Smart has access to permissions (Location, Bluetooth, Nearby devices). Then turn on Bluetooth and Location. Connect to 2.4GHz Wi-Fi network to which you want to assign the device.

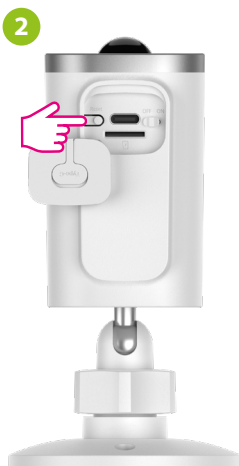

Make sure the camera is powered on. Then press and hold the button on the back of the camera for approximately 8 seconds, until the beep. The red LED on the front of the unit will then start flashing. The pairing mode is enabled.

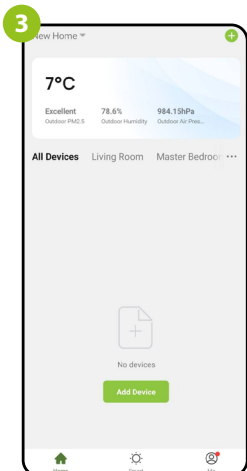

In the app, select „Add Device“.

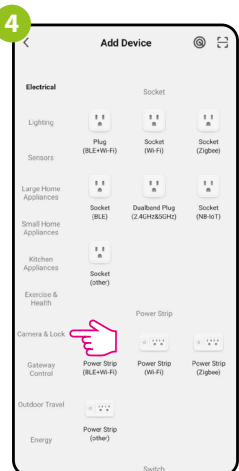

Select „Camera & Lock“.

### CONNECT CAMERA TO WI-FI

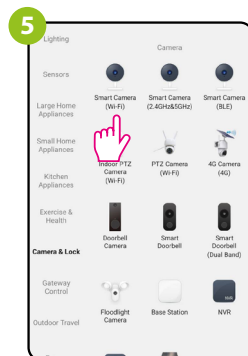

Find and click on the Wi-Fi camera in the device list.

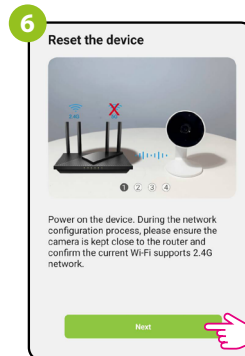

Then go „Next“.

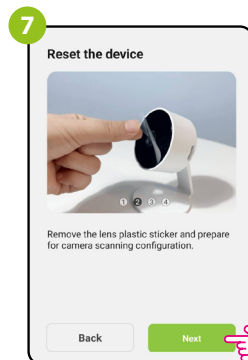

Follow the instructions displayed on the smartphone screen.

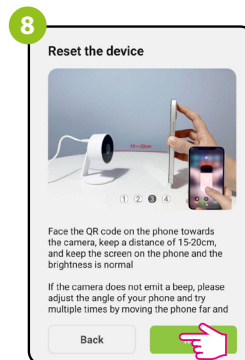

Then go „Next“.

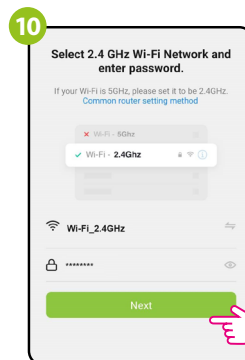

Select the Wi-Fi network in which the camera will operate and enter the password of this network.

### CONNECT CAMERA TO WI-FI

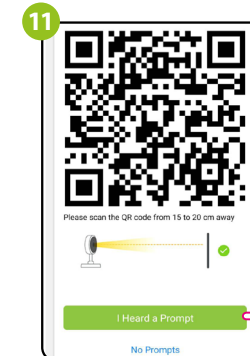

Point the camera at the QR code displayed in the app, click „I heard the sound“ after the beep.

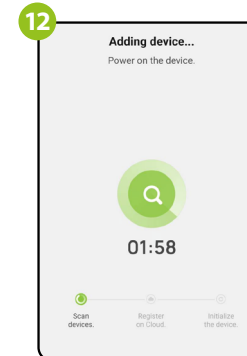

Wait for the app to configure the device with the selected Wi-Fi network.

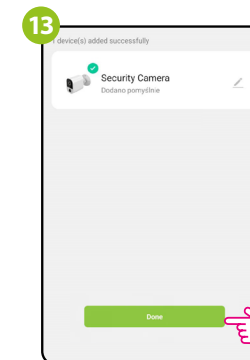

Go „Done“.

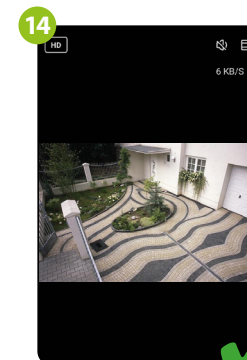

The camera has been installed and displays the main interface.

### Factory reset

To restore the default settings of the camera, hold down the Reset button for about 8 seconds until a beep sounds. Then release the button. The camera will restart, restore the default (factory) settings and be ready to be added to the application again.

